



An inspection certificate is supplied as standard. Refer to page U-11 for details.

DIMENSIONS

Horizontal

unit: mm

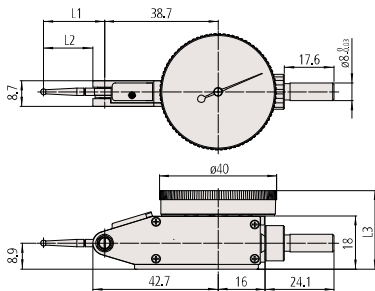

Order No.	L1	L2	L3
513-401-10E	14.7	11.2	27
513-471-10E			
513-405-10E/A/T	18.7	15.2	
513-475-10E			
513-425-10E/A	20.9	17.4	28
513-404-10E/A/T			
513-474-10E	22.2	18.7	28
513-424-10E/A/T			
513-426-10E/A	37.4	33.9	27
513-478-10E			
513-414-10E/A/T			
513-415-10E/A/T			
513-477-10E	44.5	41.0	

Compact

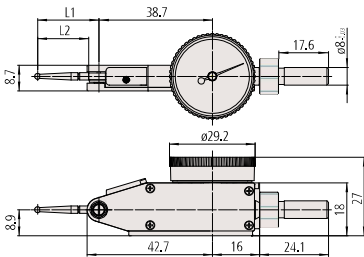

Type	Order No.	L1	L2
Compact	513-465-10E	18.7	15.2
	513-464-10E	20.9	17.4
	513-466-10E	22.2	18.7

Note: A slight difference may occur depending on the center of the contact point, graduation plate, and stem fixing position, etc.

Special Set: 513-908-10E (Metric)

513-404-10E: Dial test indicator
7014-10: Mini magnetic stand

513-907-10E (inch)

513-402-10E: Dial test indicator
7014E-10: Mini magnetic stand



Dial Test Indicator SERIES 513 — Horizontal Type

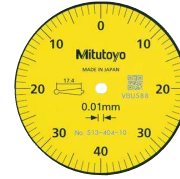

Graduation: 0.01 mm
Range: 0.8 mm

513-404-10E / 10A / 10T

- Standard
- Carbide contact point (Slightly magnetic)

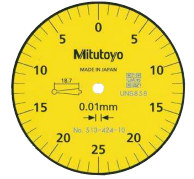

Graduation: 0.01 mm
Range: 0.5 mm

513-424-10E / 10A / 10T

- Standard
- Double scale spacing
- Carbide contact point (Slightly magnetic)

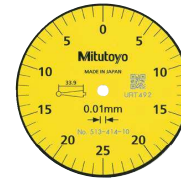

Graduation: 0.01 mm
Range: 0.5 mm

513-414-10E / 10A / 10T

- Long stylus
- Carbide contact point (Slightly magnetic)

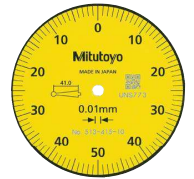

Graduation: 0.01 mm
Range: 1.0 mm

513-415-10E / 10A / 10T

- Long stylus
- Carbide contact point (Slightly magnetic)

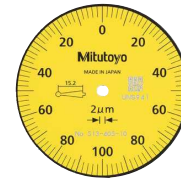

Graduation: 0.002 mm
Range: 0.2 mm

513-405-10E / 10A / 10T

- Standard
- Carbide contact point (Slightly magnetic)

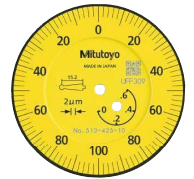

Graduation: 0.002 mm
Range: 0.6 mm

513-425-10E / 10A

- With revolution counter
- Carbide contact point (Slightly magnetic)

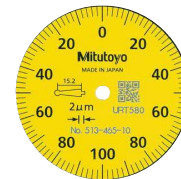

Graduation: 0.002 mm
Range: 0.2 mm

513-465-10E

- Compact
- Carbide contact point (Slightly magnetic)

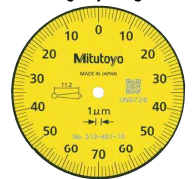

Graduation: 0.001 mm
Range: 0.14 mm

513-401-10E

- High accuracy
- Carbide contact point (Slightly magnetic)

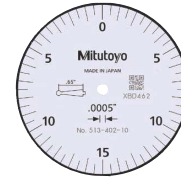

Graduation: 0.0005 in
Range: 0.03 in

513-402-10E / 10T

- Standard
- Carbide contact point (Slightly magnetic)

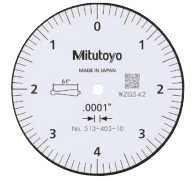

Graduation: 0.0001 in
Range: 0.008 in

513-403-10E / 10T

- Standard
- Carbide contact point (Slightly magnetic)

Note: 513-4XX-10 is indicated on the dial face. But the Order No. for the Special Set provided with the stem etc. has a suffix (E or T) at the end.